

Anaconda Head

Anaconda Head

Trigger: Garage Door (Same as Anaconda Tail)

Power In: 12VDC 5A

The 4 Relay Outputs Control these devices:

- 1: DC 12V - Linear Actuator Extend
- 2: DC 12V - Linear Actuator Retract
- 3: AC 110V - Solenoids for fire and water
- 4: AC 110V - Red floodlights (eyes) and Igniters

Ambient Audio: Spooky woods noises: Owls, coyotes, bats, footsteps.

Scare Audio: Loud hissing for 6-12 sec at a time, at 00s, 10s, and 30s.

Controller: PicoBoo Plus



FP DC 12V 5A



Garage Door Sensor (same sensor as Snake Tail)



Non-powered speaker driven by PicoBoo Plus's 30W output.

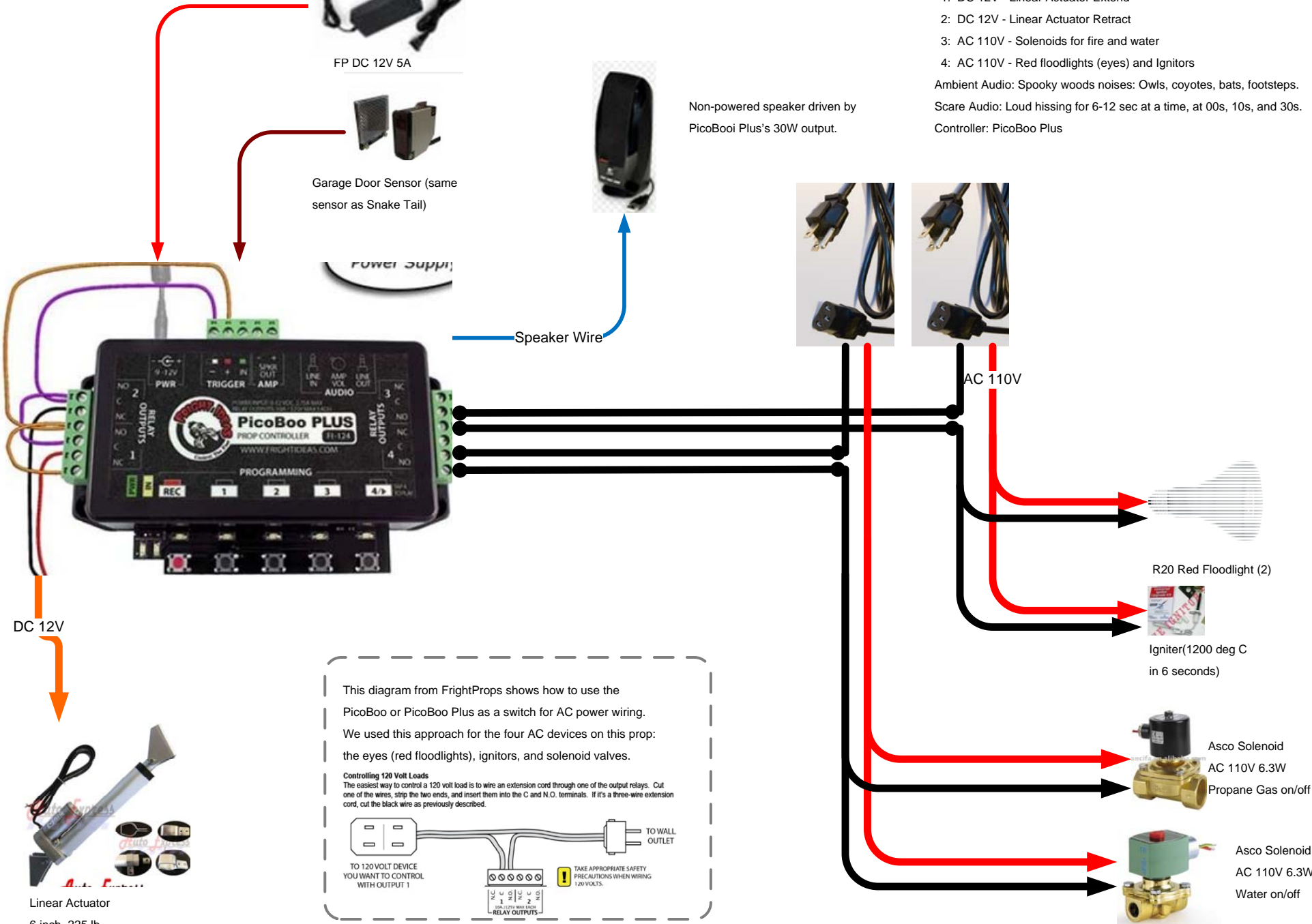

DC 12V



Linear Actuator
6 inch, 225 lb

This diagram from FrightProps shows how to use the PicoBoo or PicoBoo Plus as a switch for AC power wiring. We used this approach for the four AC devices on this prop: the eyes (red floodlights), igniters, and solenoid valves.

Controlling 120 Volt Loads
The easiest way to control a 120 volt load is to wire an extension cord through one of the output relays. Cut one of the wires, strip the two ends, and insert them into the C and N.O. terminals. If it's a three-wire extension cord, cut the black wire as previously described.

TO 120 VOLT DEVICE YOU WANT TO CONTROL WITH OUTPUT 1

TO WALL OUTLET

! TAKE APPROPRIATE SAFETY PRECAUTIONS WHEN WIRING 120 VOLTS.

AC 110V

R20 Red Floodlight (2)

Igniter(1200 deg C in 6 seconds)

Asco Solenoid
AC 110V 6.3W
Propane Gas on/off

Asco Solenoid
AC 110V 6.3W
Water on/off